



# INSTRUCTION MANUAL

---

Before using the TV, please read this manual thoroughly, and retain it for future reference.



**Model: RLDV3282A-B  
RLDEDV3255-A-C**



**Intertek**  
EP4008554

**ENERGY  
PERFORMANCE  
VERIFIED  
RENDEMENT  
ENERGETIQUE  
VERIFIE**



## CONTENTS

1	<b>SAFETY PRECAUTION</b>		1
2	<b>ENERGY STAR QUALIFICATION</b>		2
3	<b>ACCESSORIES</b>		3
4	<b>GETTING STARTED</b>		3
5	<b>CONTROL REFERENCE GUIDE</b>	Remote Control	4
		Front View	6
		Back View	6
6	<b>CONNECTIONS</b>	Antenna Connection	8
		AV Connection	8
		Y Pb Pr Connection	9
		HDMI Connection	9
		VGA Connection	10
		Headphone Connection	10
		Power Cord Connection	10
		Coax( SPDIF ) Connection	11
7	<b>WALL MOUNT INSTALLATION</b>		12
8	<b>INITIAL SETUP</b>	Putting The Unit On A Proper Place	13
		Turning The Unit On For The First Time	13
		Source selection	13
9	<b>TV SETUP</b>	Picture Menu	15
		Audio Menu	17
		Time Menu	19
		Setup Menu	20
		LOCK(Parental) Menu	23
		TV(CHANNEL) Menu	26
		Zoom Function	27

## CONTENTS

10	DISPLAY MODE	PC Formats Video Formats	28 29
11	DVD OPERATING INSTRUCTIONS		30
12	SPECIFICATION		38
13	TROUBLE- SHOOTING GUIDE	TV Symptom	39

**SAFETY CLASS : This is an IEC safety class II product.**

## SAFETY PRECAUTION



The lightning flash with arrowhead symbol, within an equilateral triangle is intended to alert the user to the presence of uninsulated dangerous voltage within the product's enclosure that may be of sufficient magnitude to constitute a risk of electric shock.



The exclamation point within an equilateral triangle is intended to alert the user to the presence of important operating and maintenance (servicing) instructions in the literature accompanying the appliance.

**WARNING:** TO PREVENT FIRE OR SHOCK HAZARD, DO NOT EXPOSE THIS APPLIANCE TO RAIN OR MOISTURE.

**CAUTION:** TO PREVENT ELECTRIC SHOCK DO NOT USE THIS POLARIZED PLUG WITH AN EXTENSION CORD, RECEPTACLE OR OTHER OUTLET UNLESS THE BLADES CAN BE FULLY INSERTED TO PREVENT BLADE EXPOSURE.

**CAUTION:** These servicing instructions are for use by qualified service personnel only. To reduce the risk of electric shock, do not perform any servicing other than that contained in the operating instructions unless you are qualified to do so.

### Important Safety Instructions

- 1) Read these instructions.
- 2) Keep these instructions.
- 3) Heed all warnings.
- 4) Follow all instructions.
- 5) Do not use this apparatus near water.
- 6) Clean only with dry cloth.
- 7) Do not block any ventilation openings. Install in accordance with the manufacturer's instructions.
- 8) Do not install near any heat sources such as radiators, heat registers, stoves, or other apparatus (including amplifiers) that produce heat.
- 9) Do not defeat the safety purpose of the polarized or grounding-type plug. A polarized plug has two blades with one wider than the other. A grounding type plug has two blades and a third grounding prong. The wide blade or the third prong are provided for your safety. If the provided plug does not fit into your outlet, consult an electrician for replacement of the obsolete outlet.
- 10) Protect the power cord from being walked on or pinched particularly at plugs, convenience receptacles, and the point where they exit from the apparatus.
- 11) Only use attachments/accessories specified by the manufacturer.
- 12) Use only with the cart, stand, tripod, bracket, or table specified by the manufacturer, or sold with the apparatus. When a cart is used, use caution when moving the cart/ Apparatus combination to avoid injury from tip-over.
- 13) Unplug this apparatus during lightning storms or when unused for long periods of time.
- 14) Refer all servicing to qualified service personnel. Servicing is required when the apparatus has been damaged in any way, such as power-supply cord or plug is damaged, liquid has been spilled or objects have fallen into the apparatus, the apparatus has been exposed to rain or moisture, does not operate normally, or has been dropped.
- 15) The apparatus shall not be exposed to dripping or splashing and that no objects filled with liquids, such as vases, shall be placed on the apparatus.
- 16) The mains plug or appliance inlet is used as the disconnect device, remain it readily operable during the apparatus normal use.



Caution marking is located at the rear of the apparatus. Attention marquage est situé sur le panneau arrière de l'unité.

The marking information is located at the rear of apparatus. Le marquage est situé sur le panneau arrière de l'unité.

**WARNING:** To reduce the risk of fire or electric shock, do not expose this apparatus to rain or moisture.

**Avertissement:** pour réduire le risque d'incendie ou de choc électrique, ne pas exposer cet appareil sous la pluie et l'humidité.

**WARNING:** The battery (battery or batteries or battery pack) shall not be exposed to excessive heat such as sunshine, fire or the like.

Les piles ne doivent pas être exposées à de forte chaleur, tel qu'à la lumière du soleil, au feu ou autres choses de semblable.

**WARNING:** Excessive sound pressure from earphones and headphones can cause hearing loss.

Des pressions acoustiques excessives provenant écouteurs ou de casques peuvent provoquer des pertes de l'audition.

L'appareil ne doit pas être exposé aux écoulements ou aux éclaboussures et aucun objet ne contenant de liquide, tel qu'un vase, ne doit être placé sur l'objet.

La prise du secteur est utilisé pour déconnecter le système. La prise du secteur ne doit pas être obstruée ou doit être facilement accessible pendant son utilisation. Pour être complètement déconnecté de l'alimentation d'entrée, la prise doit être débranchée du secteur.



# ENERGY STAR Qualification



## ENERGY STAR® Qualification.

This product has earned the ENERGY STAR® for meeting U.S. Federal energy efficiency guidelines as set by the Department of Energy and Environmental protection agency.

The ENERGY STAR® program exists to provide energy saving guidelines and help promote energy efficient products and practices. Changes to certain features, settings and functions of this TV can change and/or increase its power consumption.

**Home Mode** is the mode in which the product qualifies for ENERGY STAR®.

**Standard Mode** optimizes the video effects when use at a retail showroom or demo environment. This mode the video setting may increase energy consumption beyond the limits required for ENERGY STAR® qualification.

## MENU OPERATION

### Basic Operations

Press ▲ / ▼ button to select your desired mode, then press ENTER button to enter.



## ACCESSORIES

Please check and identify the supplied accessories.

Remote control .....	x 1
Battery(AAA) .....	x 2
Warranty Card .....	x 1
Instruction Manual .....	x 1
Base stand and 2 screws .....	x 1

## GETTING STARTED

### USING THE REMOTE CONTROL

- Point the remote control at the remote sensor located on the unit.
- When there is a strong ambient light source, the performance of the infrared remote sensor may be degraded, causing unreliable operation.
- The recommended effective distance for remote operation is about 16 feet (5 meters).

### TO INSTALL THE BATTERIES

1. Open the battery door.

2. Insert 2 "AAA" batteries

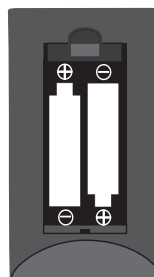

### BATTERY REPLACEMENT

When the batteries become weak, the operating distance of the remote control is greatly reduced and you will need to replace the batteries.



**CAUTION** : Danger of explosion if battery is incorrectly replaced.

### NOTES

- If the remote control is not going to be used for a long time, remove the batteries to avoid damage caused by battery leakage corrosion.
- Do not mix old and new batteries. Do not mix ALKALINE, standard (CARBON-ZINC) or rechargeable (NICKEL-CADMIUM) batteries.
- Always remove batteries as soon as they become weak.
- Weak batteries can leak and severely damage the remote control.



### WARNING :

Do not dispose batteries in a fire. Batteries may explode or leak.  
Batteries shall not be exposed to excessive heat such as sunshine, fire or the like.

# CONTROL REFERENCE GUIDE

## REMOTE CONTROL

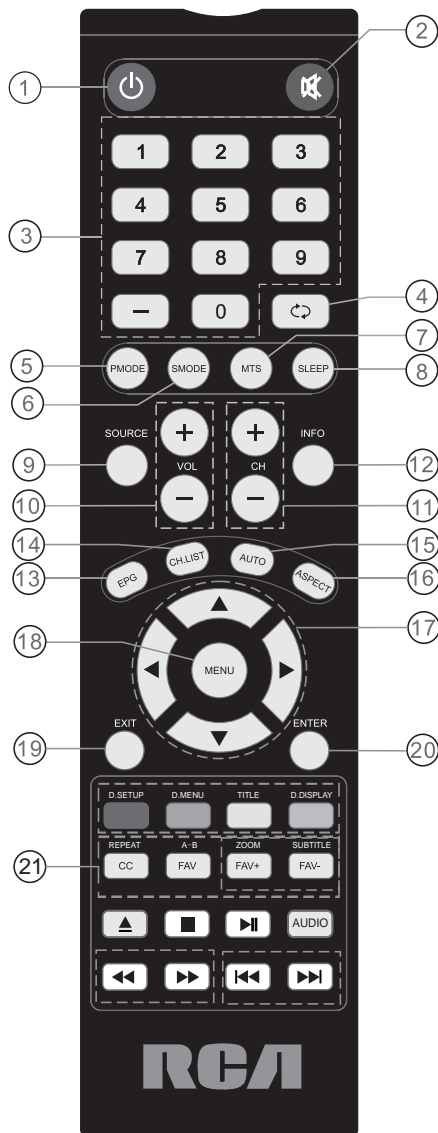

1. **STANDBY**  
To switch on the TV or make the TV into standby mode.
2. **MUTE**  
Press this button to mute or restore sound.
3. **0-9**  
Allows you to change the channel of the TV.
4. **↔**  
Switches back and forth between the current and previous channels.
5. **PMODE**  
Press this button to select a picture mode for different picture qualities.
6. **SMODE**  
Press this button to select sound setting for different sound effects.
7. **MTS**  
To change among STEREO, MONO and SAP. If there is no second language available for the signal received, LED Display audio will output to mono.
8. **SLEEP**  
To select the amount of time before your TV turns Off automatically.
9. **SOURCE**  
Press this button to select an input source.
10. **VOL+/VOL-**  
Increases/Decreases the Volume control.
11. **CH+/CH-**  
Skips to the next/previous channel on TV mode.
12. **INFO**  
Show the information of the program you are watching.
13. **EPG**  
Press this button to select the electronic programme guide in DTV mode.
14. **CH.LIST**  
Display program list.
15. **AUTO**  
Press to do auto configuration directly(PC MODE).
16. **ASPECT**  
Select the aspect ratio settings:Wide/Zoom/Cinema/Normal(In PC Mode:Wide/dot to dot).
17. **UP/DOWN/LEFT/RIGHT**  
Moves the cursor upward/downward/to the left/to the right when making a selection.
18. **MENU**  
Displays the OSD Menu of the TV.
19. **Exit**  
Press this button to exit the on screen display.
20. **ENTER**  
Press to confirm selections on a menu screen.
21. **CC/FAV /FAV+/ FAV-**  
Press the button to enter into the CC mode.  
Press this button to show the favourite list.  
Press this button to go through the FAV channel list.

"Remarks: The Universal Remote code is 808F."

## CONTROL REFERENCE GUIDE

### REMOTE CONTROL

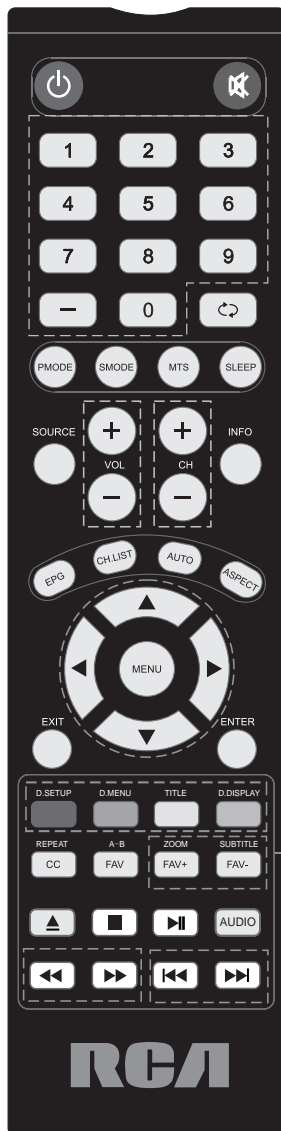

#### **D.SETUP**

Used for selecting programs. It may also be used to execute commands.

#### **D.MENU**

DVD disc menu Access to menu.

#### **TITLE**

When DVD is playing, bring up the TITLE MENU.

#### **D.DISPLAY**

Press to display the DVD information of DVD mode.

#### **REPEAT**

Press REPEAT to cycle through the repeat play options.

#### **A-B**

This button enables you to repeat a selected section from the disc.

#### **ZOOM**

In play state, press ZOOM, the player will zoom in the picture one time.

#### **SUBTITLE**

Select a different subtitle language (the DVD disc must have the subtitle you selected).



To eject the disc.



DVD STOP.



PLAY/PAUSE in DVD mode.

#### **AUDIO(I/II)**

AUDIO selection buttons in DVD mode.



Fast backward and forward key.



Jump to previous and next track.

# CONTROL REFERENCE GUIDE

## FRONT VIEW

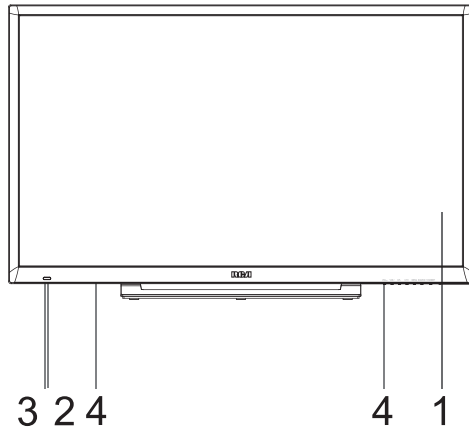

- 1.Color Screen
- 2.Standby Indicator  
Indicates whether the unit is ON  
or in STANDBY (OFF) mode.  
Light in red: The unit is in STANDBY.  
Light in blue:The unit is turned ON.
- 3.Remote Sensor  
Do not block this sensor or the  
remote control will not work.
4. Speakers

## BACK VIEW

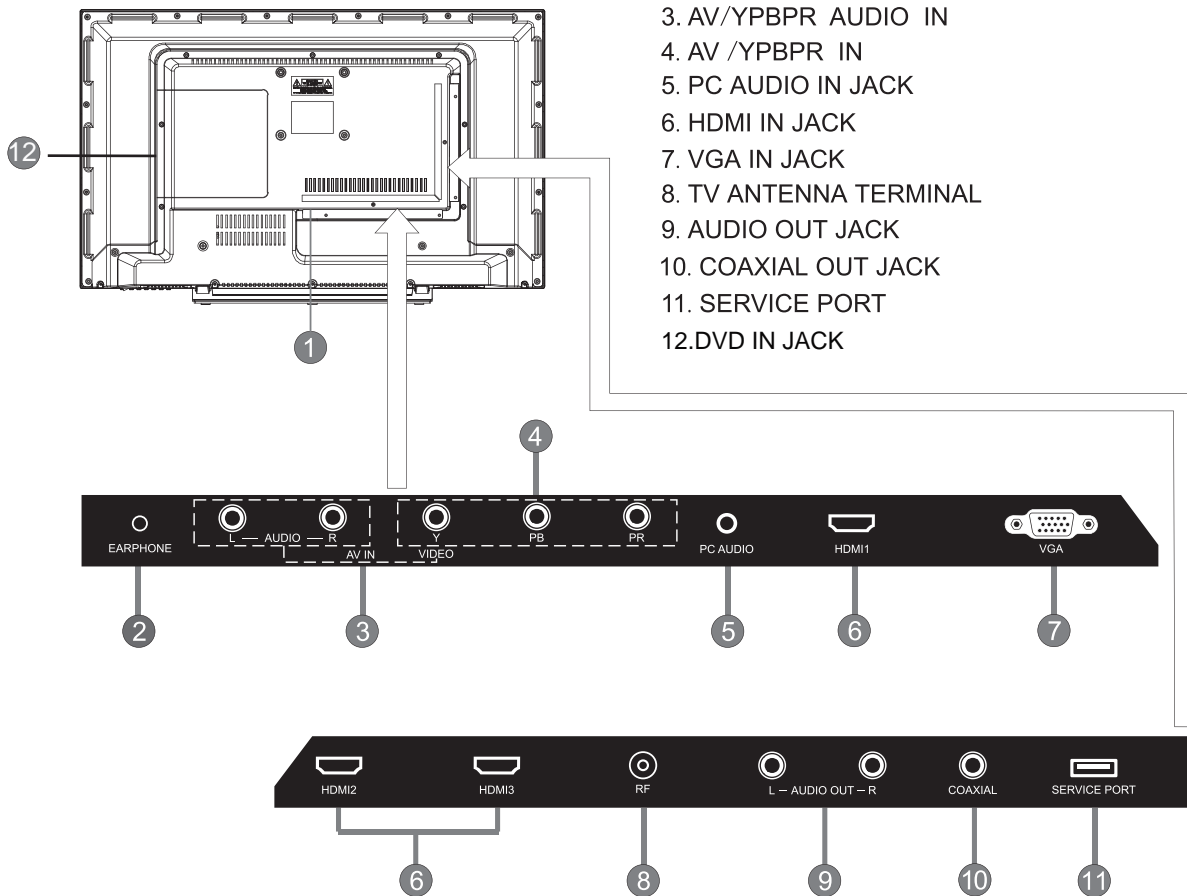

1. POWER CORD
2. HEADPHONE JACK
3. AV/YPBPR AUDIO IN
4. AV /YPBPR IN
5. PC AUDIO IN JACK
6. HDMI IN JACK
7. VGA IN JACK
8. TV ANTENNA TERMINAL
9. AUDIO OUT JACK
10. COAXIAL OUT JACK
11. SERVICE PORT
- 12.DVD IN JACK

## CONTROL REFERENCE GUIDE

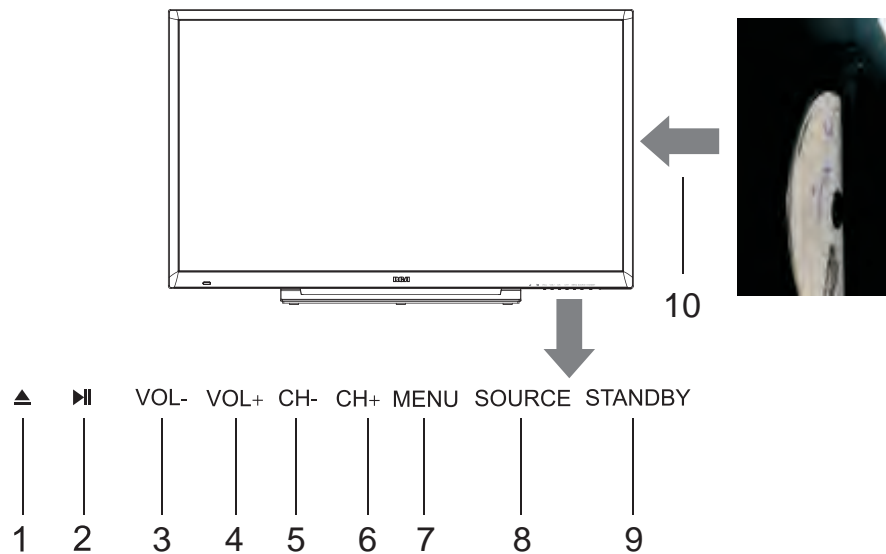

- 1: ▲  
Leaves the warehouse/to place in storage.
- 2: ▶▶  
Broadcast/suspension.
- 3. VOL- Button  
Press to adjust the volume down.
- 4. VOL+ Button  
Press to adjust the volume up.
- 5. CH- Button  
Press to change the TV channels and down highlight selections on the menu screen.
- 6. CH+ Button  
Press to change the TV channels and up highlight selections on the menu screen.
- 7. MENU Button  
Press to display the on-screen TV menu.
- 8. SOURCE Button  
Press to select the input source of the TV.
- 9. STANDBY Button  
Press to turn the unit on and off.
- 10. The small dish piece inserts the entrance.

# CONNECTIONS

## CONNECTING A TV ANTENNA / CABLE / SATELLITE

To view television channels correctly, a signal must be received from one of the following sources:

- An indoor or outdoor aerial antenna
- A cable system
- A satellite system

### NOTE

For receiving over-the-air TV broadcasts, we recommend that you use an external fixed antenna. Should you require the use of a temporary antenna, please ensure that you purchase an antenna with sufficient ability to receive in weak signal areas. Only when you are in close proximity to a transmitter will a temporary antenna reproduce a signal as strongly as a fixed antenna.

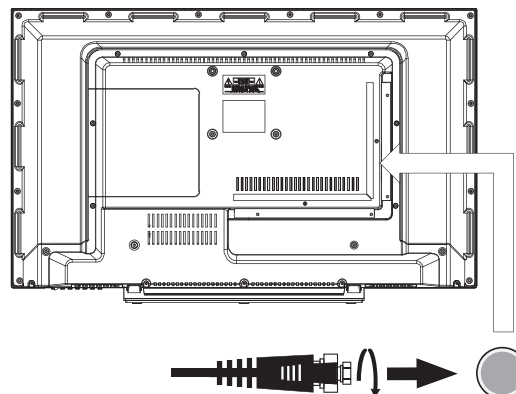

Satellite, cable or TV antenna cable to TV ANTENNA terminal (cable not included)

## CONNECTING AN A/V DEVICE

To connect to other equipment such as a VCR, camcorder, satellite system or cable, etc.

## CONNECTING DEVICES WITH A COMPOSITE (YELLOW RCA-TYPE) VIDEO OUTPUT

To connect A/V devices such as a VCR, video game system or camcorder.

### Connecting to a VCR / Video Game System / Camcorder

Connect the AUDIO / VIDEO cable (not included) as shown.

Make sure you connect the cable from the other equipment ( **AUDIO** and **VIDEO OUT** ) to this unit (AV in)

### NOTE

Please refer to the user manual for the other equipment for more information.

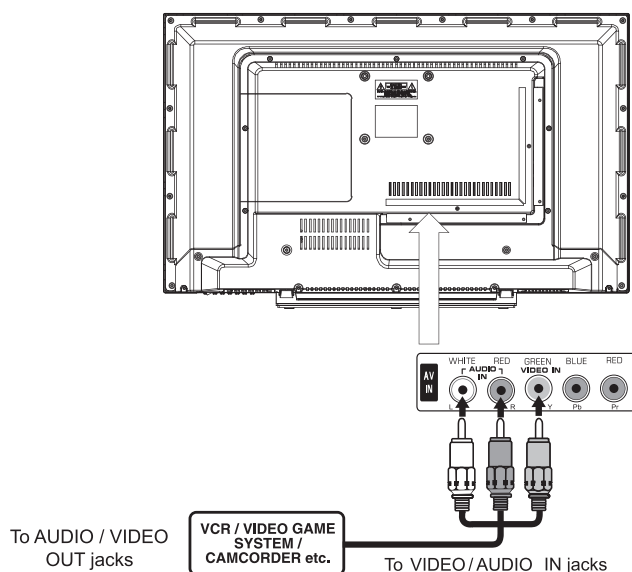

# CONNECTIONS

## CONNECTING A HIGH-DEFINITION (HD) SOURCE USING COMPONENT CONNECTION

High-Definition (HD) Devices with component video output must be connected to the YPbPr input.

Connect the component video cable and audio cable (not included) as shown.

Make sure you connect the component video cable and audio cable from the other equipment (COMPONENT OUT and AUDIO OUT) to the unit COMPONENT IN.

### NOTE

When connecting a DVD player to the television, the picture resolution is solely dependent upon the resolution supported by the DVD player attached. DVD player resolutions vary from 480i to 1080p, and this television can support DVD players up to a maximum resolution of 1080p.

\* May require a subscription for receiving HD channels, check with your cable/satellite service provider for details.

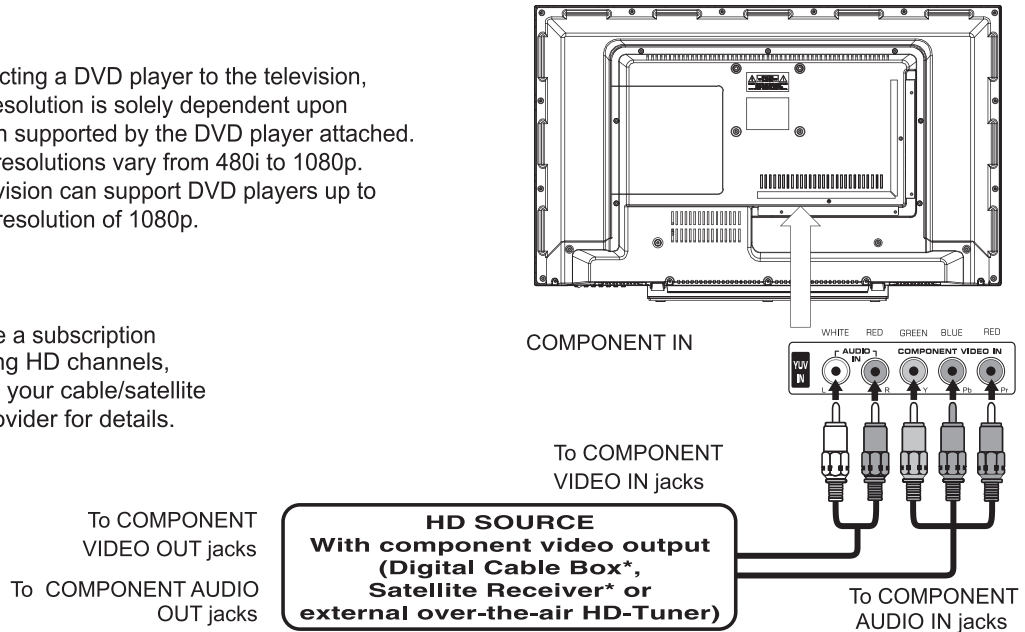

## CONNECTING A HIGH-DEFINITION (HD) SOURCE USING HDMI CONNECTION

HDMI (High Definition Multimedia Interface) supports both video and audio on a single digital connection for use with DVD players, DTV, set-topboxes and other digital AV devices. HDMI was developed to provide the technologies of High Bandwidth Digital Content Protection (HDCP) as well as Digital Visual Interface (DVI) in one specification. HDCP is used to protect digital content transmitted and received by DVI-compliant or HDMI-compliant displays.

HDMI has the capability to support standard, enhanced or high-definition video plus standard to multi-channel surround-sound audio. HDMI features include uncompressed digital video, a bandwidth of up to 2.2 gigabytes per second (with HDTV signals), one connector (instead of several cables and connectors), and communication between the AV source and AV devices such as DTVs.

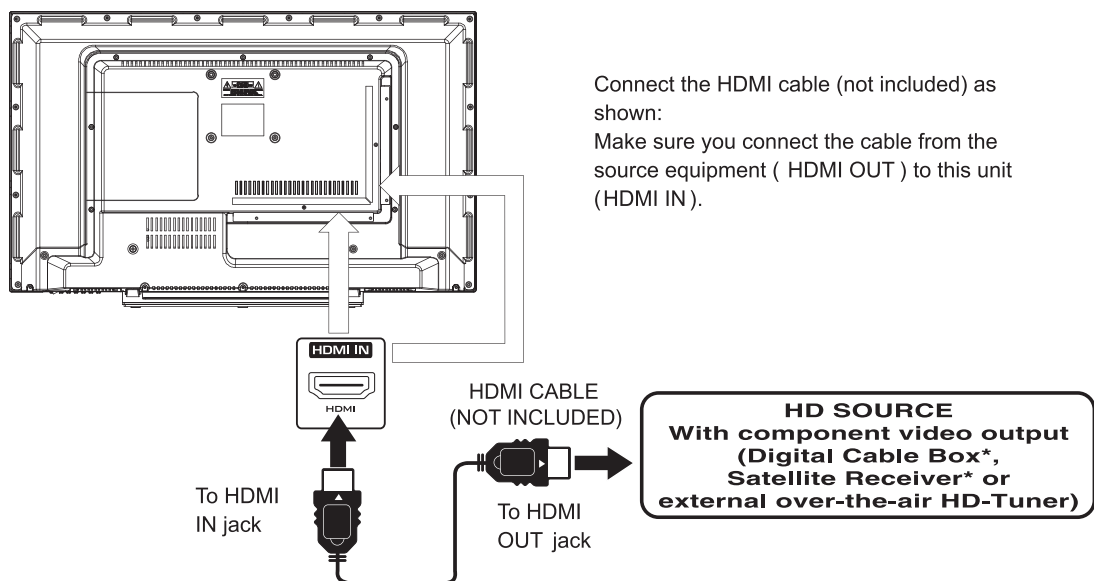

Connect the HDMI cable (not included) as shown:

Make sure you connect the cable from the source equipment (HDMI OUT) to this unit (HDMI IN).



# CONNECTIONS

## CONNECTING A PC

Connect the 15-pin D-SUB PC/VGA connector from your computer to the 15-pin D-SUB PC/VGA input on this unit using a monitor cable and an audio cable (not included) as shown.

Make sure you connect the cable from the computer (VGA and AUDIO - PC OUT ) to this unit (VGA and AUDIO - PC IN ).

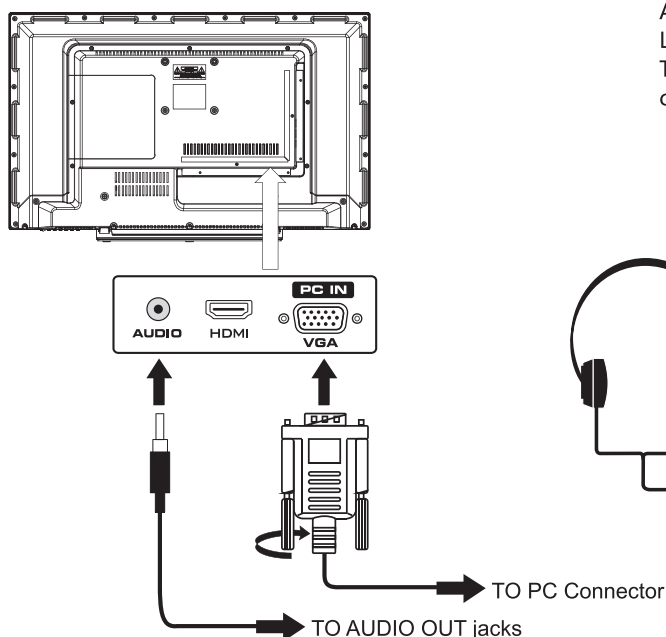

## CONNECTING HEADPHONES

- Turn down the volume before connecting headphones to the unit, then adjust the volume to your desired level.
- When headphones are connected, no sound will come from the front speakers.

### NOTE

Avoiding listening to sound at high Levels for prolonged period of time. This may be harmful to you and may cause hearing loss.

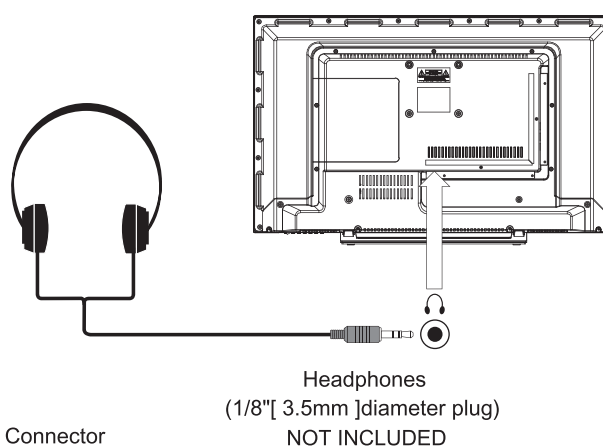

## CONNECTING THE POWER CORD

You can power on your TV unit before you make sure the power cord is inserted well.

At the same time, please check that the rated voltage of your unit matches your local Voltage.

### NOTE

- Insert the power plug fully into the socket outlet (If the power plug is loose, it could generate heat and cause fire.)
- Ensure that the power plug is easily accessible.
- Ensure the earth pin on the power plug is securely connected to prevent electrical shock.
- An apparatus with CLASS II construction shall be connected to a power socket outlet connection.
- Do not touch the power plug with a wet hand (This may cause electrical shock.)
- Do not use any power cord other than that provided with this TV. ( This may cause fire or electrical shock.)
- Do not damage the power cord (A damaged cord may cause fire or electrical shock).
- Do not move the TV with the cord plugged in the socket outlet.
- Do not place a heavy object on the cord or place the cord near a high-temperature object.
- Do not twist the cord, bend it excessively, or stretch it.
- Do not pull on the cord. Hold onto the power plug body when disconnecting cord.
- Do not use a damaged power plug or socket outlet.

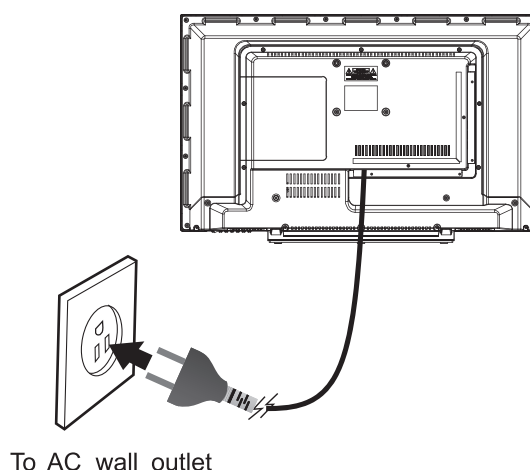

## CONNECTIONS

### Connection to a Home Theater Audio System

#### For BEST audio performance

Connecting to a Home Theater System  
Dolby Digital can deliver optimal 2 channel stereo or surround sound with five discrete full range channels plus a sixth channel for a subwoofer.

Enjoy optimal sound reproduction from your system with a Dolby Digital amplifier that incorporates a digital coaxial input. Connect an optional digital cable directly to the television's Coax audio output to listen through all inputs except VGA.

( The VGA does not support digital audio )

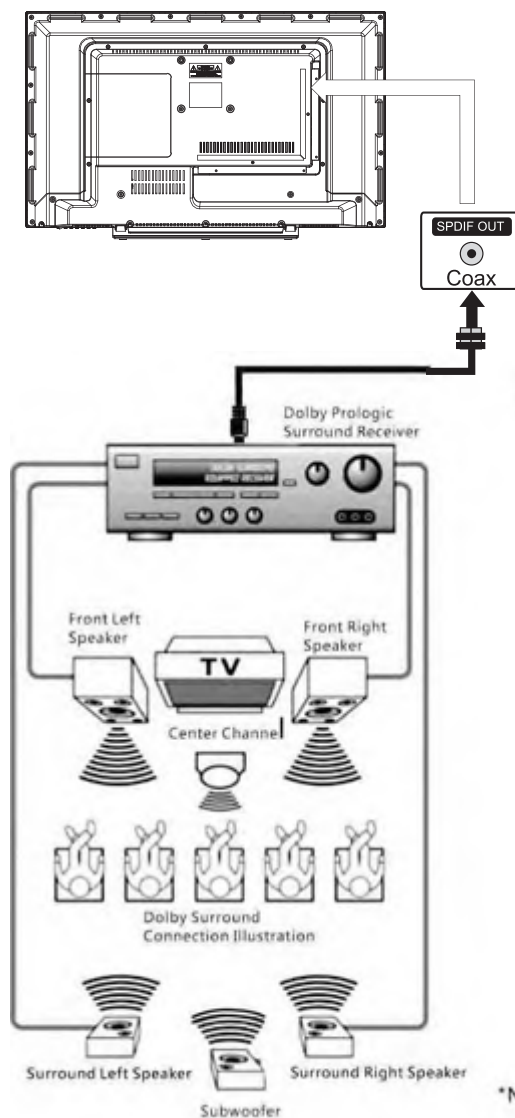

#### How To Setup Digital Output

Press the MENU button on the remote control  
Press the right ► arrow button to select AUDIO  
Press the down ▼ arrow button to highlight SPDIF Type right ► Raw or PCM



optional digital cable

\*NOTE: Refer to the User Manual from your home theater equipment for recommended audio settings.

# WALL MOUNT INSTALLATION

## INSTALLING / REMOVING THE BASE STAND

### WARNING:

The LED Display is very fragile, and must be protected at all times when removing the base stand. Be sure that no hard or sharp object or anything that could scratch or damage the LED display comes into contact with it. Do not exert pressure on the front of the unit at any time because the screen could crack.

1. Disconnect all cables or cords connected to the unit.
2. Lay the unit down on a flat surface with the back side facing up. Please make sure to place a soft cushioned material (such as a pillow or thick piece of foam) beneath the screen.
3. To remove the base stand, loosen screws off the holes then pull downwards to release the base stand.
4. To install the base stand, put the stand into the hole at the bottom of the TV then insert screws to the holes and tighten.

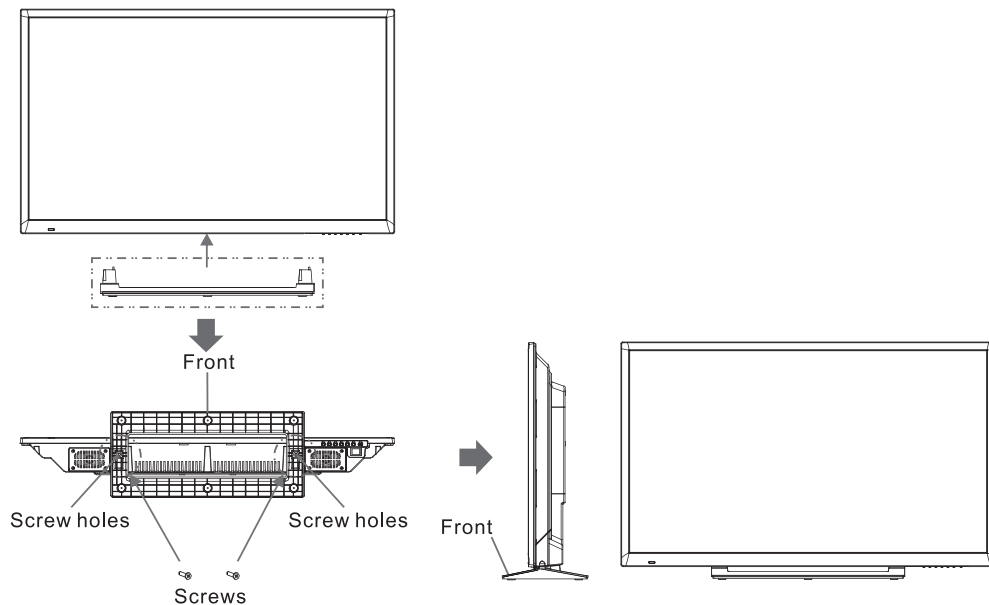

## MOUNTING ON THE WALL

This unit is VESA-compliant, and is designed to be wall-mounted with a VESA-compliant 3.9" x 3.9" (100mm x 100mm) mounting kit designed for flat-panel TVs(not supplied). Mount this unit according to the instructions included in the mounting kit.

### NOTE

Remove the base stand before mounting the unit on the wall.

- 1\*-- The length of the two screws(size M5 screw ) should not exceed 20 mm.
- 2\*--When installing a wall hanging, please remove the shell after the two ST4 x 8 self-tapping screws (see chart), put on the hanging bracket, use remove ST4 x 8 self-tapping screw assembly in the original position (not screws substitute) with it.

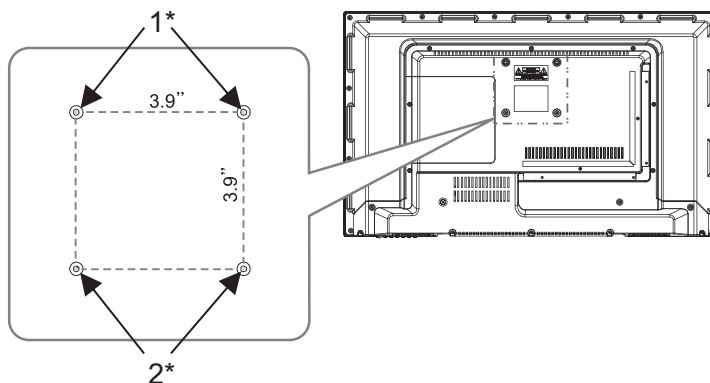

# INITIAL SETUP

## PUTTING THE UNIT ON A PROPER PLACE

When you turn on your television set for the first time, be sure to place it on a solid stable surface.

To avoid danger, do not expose the TV to water, or a heat source (e.g. lamp, candle, radiator).

Do not obstruct the ventilation grid at the rear and be sure to leave sufficient gaps around the unit.



## TURNING THE UNIT ON FOR THE FIRST TIME

After you have initially connected your TV antenna or cable, turn the television ON.

A screen will display asking you to run a **Channel Auto Scan** to search and receive available local digital channels.

It is here where you will select antenna options and run **Channel Auto Scan**.

Channels will be stored in the TV tuner.

Press the **MENU** button on the remote control. Using the ◀ ▶ buttons, scroll to highlight **TV** mode. Press the ▼ button to highlight **AIR/CABLE**.

Please Run Channel Auto Scan

## SOURCE SELECTION

1. Press the **SOURCE** button on the remote control.
2. Use the ▲ or ▼ button to select the options (TV, YPbPr/AV, HDMI1, HDMI2, HDMI3, PC) and select any of them using the ▶ button or the **ENTER** button.  
(The screen will change to your desired source).

Note:

1. Before watching please make sure all necessary cables and devices are connected.
2. When connecting the component or AV of DVD devices, First select Component/AV, then the upper right corner of the screen will display corresponding Component or AV.

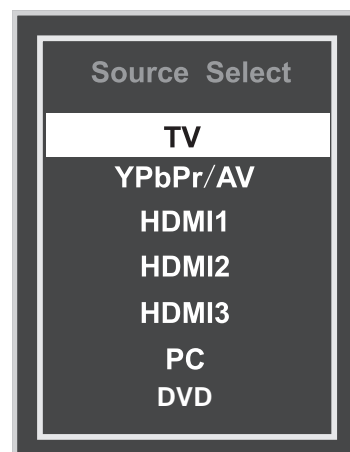

# INITIAL SETUP

## How to Navigate

**Air Mode:** Select **AIR** when connected to an indoor/outdoor antenna.



Press the ▼ button to highlight **AIR**.



Press the ▼ button to select **AUTO SCAN** then press the ► button to start Channel Auto Scan.

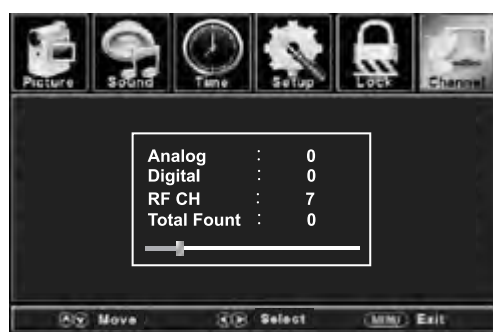

Channel Auto Scan may take several minutes to complete.

**NOTE:** For cable or satellite users with no TV antenna, there no need to run Channel Auto Scan. Connect your cable or satellite set top box to one of the available inputs on the TV for viewing.

**Cable Mode:** Select **CABLE** if you subscribe to a pay television service including satellite.



Using the ◀▶ button to highlight **CABLE**.



Press the ▼ button to select **AUTO SCAN**. Press the ENTER button and the cursor will move up and **CABLE SYSTEM** will be displayed next. Press ► the button to select **STD > IRC > HRC > Auto** (Auto is recommended). Press the ▼ button to select **Auto Scan** and press ENTER to start Channel Auto Scan.

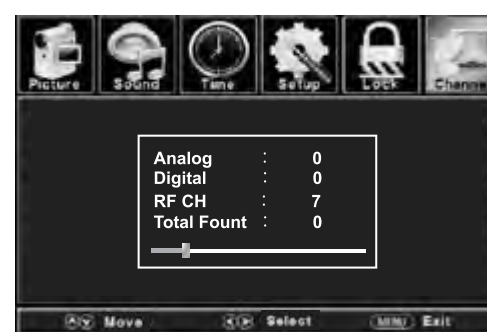

Channel Auto Scan may take several minutes to complete.

## TV SETUP



### PICTURE MENU

The PICTURE menu offers options to enhance and refine the picture displayed on your TV based on ambient room light and personal preferences.

Adjustment options include contrast, brightness, color, tint, sharpness and color mode.

#### How to Navigate:

Press the MENU button on the remote control. Navigate using the ◀▶ buttons to select PICTURE.



Press the ▼ button to highlight , then press the ▶ button to select your viewing preference from 4 factory options:  
STANDARD > DYNAMIC > SOFT > USER  
> ENERGY SAVING

The STANDARD setting is recommended for most viewing environments.

Depending on the ambient light level in the room, you may find one of the other options more pleasing.

#### To make more critical picture adjustments based on your own preferences in USER:

Use the ▼ button to highlight Contrast.  
Navigate using the ◀▶ buttons to increase or decrease contrast intensity.



Use the ▼ button to highlight Brightness.  
Navigate using the ◀▶ buttons to increase or decrease overall brightness.





## TV SETUP



### PICTURE MENU

The PICTURE menu offers options to enhance and refine the picture displayed on your TV based on ambient room light and personal preferences.

Adjustment options include contrast, brightness, color, tint, sharpness and color mode.

Press the MENU button on the remote control. Navigate using the ◀▶ buttons to select PICTURE.



Use the ▼ button to highlight Color. Navigate using the ◀▶ buttons to increase or decrease color intensity.



Use the ▼ button to highlight Tint. Navigate using the ◀▶ buttons to adjust colors toward green or reddish tint.



Use the ▼ button to highlight Sharpness. Navigate using the ◀▶ buttons to soften or view crisper edges in the picture.



Use the ▼ button to highlight Color Mode. Navigate using the ◀▶ buttons to select COOL (more bluish tone), NORMAL or WARM. The default setting is NORMAL. WARM mode will provide color that is calibrated to D6500° Kelvin, the standard color that broadcast stations and the Motion Picture industry consider as the most accurate to view programming.



Use the ▼ button to highlight Advanced Settings. Navigate using the ▶ buttons to Aspect Ratio, Noise Reduction and Dynamic Contrast Functions Select.

#### Note:

When adjustments are completed, you may select another menu by pressing the Menu button.

## TV SETUP



### SOUND MENU

The SOUND menu offers options to make sound enhancements while listening through the built-in speakers and personal preferences.

Adjustment options include Sound Mode, Bass, Treble.

#### How to Navigate:

Press the MENU button on the remote control. Navigate using the ◀▶ buttons to select Sound.



Press the ▼ button to highlight Sound Mode, then press the ▶ button to select your sound preference from 4 factory options: STANDARD > MUSIC > MOVIE > USER.

The STANDARD setting is recommended for most sound environments.

Depending on the surroundings in the room, you may find one of the other options more pleasing.

To make more critical audio adjustments based on your own preferences in USER:

Use the ▼ button to highlight Bass. Navigate using the ◀▶ buttons to increase or decrease low frequency intensity.



Use the ▼ button to highlight Treble. Navigate using the ◀▶ buttons to increase or decrease high frequency intensity.





## TV SETUP



### SOUND MENU

The SOUND menu offers options to make sound enhancements while listening through the built-in speakers and personal preferences.

Adjustment options include Balance, MTS, Audio Language, SPDIF Type, Surround Sound, AVL.

#### How to Navigate:

Press the MENU button on the remote control. Navigate using the ◀▶ buttons to select SOUND.



Use the ▼ button to highlight Balance. Navigate using the ◀▶ buttons to adjust sound towards the right or left speaker.



Use the ▼ button to highlight Surround. Navigate using the ▶ button to turn the dimensional surround effect ON or OFF. (for built-in speakers only).



Use the ▼ button to highlight Digital Audio Output. Navigate using the ▶ button to adjust.



Use the ▼ button to highlight Audio Language. Navigate using the ◀▶ buttons to select to listen to an alternative language broadcast (if available) English > Spanish > French. You may select an alternative language using the remote control by pressing MTS)

#### Note:

When adjustments are completed, you may select another menu by pressing the Menu button.

## TV SETUP



### TIME MENU

The TIME menu includes adjustment of settings for your local time zone and daylight savings time. The clock will adjust automatically after the initial Channel Auto Scan of available broadcast channels in your area.

#### How to Navigate:

Press the MENU button on the remote control. Navigate using the ◀▶ buttons to select TIME.



Use the ▼ button to highlight SleepTimer, then press the ▶ button to select among: 5min, 10min, 15min, 30min, 45min, 60min, 90min, 120min, 180min, 240min and off.



Use the ▼ button to highlight TimeZone, then press the ▶ button to select among: EASTERN > CENTRAL > MOUNTAIN > PACIFIC > ALASKA > HAWAII.



Use the ▼ button to highlight Daylight Saving Time. Navigate using the ◀▶ buttons to turn this feature on or off.



Clock: Display the time at present.

#### Note:

When adjustments are completed, you may select another menu by pressing the Menu button.

## TV SETUP



### SETUP MENU

In the SETUP menu you may change the initial set up of preferences that include settings for language, menu display, computer monitoring, closed captions, enhancement of black detail in the picture and resetting your TV back to its factory default status.

#### How to Navigate:

Press the MENU button on the remote control. Navigate using the ◀▶ buttons to select SETUP.



Use the ▼ button to highlight Menu Language, Press the ▶ button to select the language you prefer among English, French and Spanish.



Use the ▼ button to highlight Input Label, Press the ▶ button to select the Input Label you prefer among TV/AV/YPbPr/HDMI1/HDMI2/HDMI3/VGA.



Use the ▼ button to highlight Transparent. Navigate using the ◀▶ buttons to 0%,25%,50%, 75%,100%.



Use the ▼ button to highlight Other Settings. Press the ▶ button to select the Audio Only to turn Off or On.



Use the ▼ button to highlight Zoom Mode. Navigate using the ◀▶ buttons to select the viewing mode: Normal > Wide > Zoom > Cinema.



Use the ▼ button to highlight Restore Default. Press the ▶ button to automatically set all adjustments back to their original settings.



When prompted, Select "Yes" to confirm.

## TV SETUP



### SETUP MENU

The SETUP menu includes adjustments for activating the Closed Caption feature for display on the television and customizing CC display types and font styles.

#### How to Navigate:



Press the MENU button on the remote control. Navigate using the ◀▶ buttons to select SETUP. Press the ▼ button to highlight Closed Caption then press the ▶ button to select from the following options.



Use the ▼ button to highlight Digital CC. Navigate using the ◀▶ buttons to select Service 1 - 6.



Use the ▼ button to highlight CC Mode. Navigate using the ◀▶ buttons to select Off > On > CC on Mute.



Use the ▼ button to highlight Option. Press the ▶ button to enter a menu with options to customize text fonts, colors and opacities.



Use the ▼ button to highlight Analog CC. Navigate using the ◀▶ buttons to select CC 1-4, Text 1-4.



#### Note:

When adjustments are completed, you may select another menu by pressing the Menu button.

## TV SETUP



### SETUP MENU

In the SETUP menu you may adjust the position of images displayed on screen once you connect an input signal from your PC. Recommended resolution is 1366 x 768.

If your PC system uses a standard signal mode, the screen will adjust automatically.

Connect an optional 3.5mm audio cable for stereo sound.

#### How to Navigate:

After connecting to a PC, press the SOURCE button and highlight VGA, then press the ENTER button.



Press the MENU button on the remote control and navigate using the ◀▶ buttons to select SETUP. Press the ▼ button to highlight PC Settings, then press the ▶ button to select from the following options.



Use the ▼ button to highlight H-POS. Navigate using the ◀▶ buttons to adjust the position of images displayed from side to side.



Use the ▼ button to highlight V-POS. Navigate using the ◀▶ buttons to adjust the position of images displayed up and down.



Use the ▼ button to highlight Clock. Navigate using the ◀▶ buttons to control the width of the image.



Use the ▼ button to highlight Phase. Navigate using the ◀▶ buttons to improve focus and image stability.



Use the ▼ button to highlight AUTO. Press the ▶ button to automatically adjust the display to the best setting.



## TV SETUP



### LOCK(PARENTAL) MENU

In the LOCK(PARENTAL) menu you may block television by inputting passwords. To gain access and select your preferences within the LOCK(PARENTAL) menu make certain your input is set to TV.

#### How to Navigate:

Press the MENU button on the remote control. Navigate using the ◀▶ buttons to select LOCK.



Press the ▼ button to highlight Enter Password. Enter your 4 digit code (factory default code is "0000") unless previously changed.



Use the numeric buttons to input a new 4 digit code by two times.



To change the password, press the ► button to display a screen to enter your new password, then confirm again.



To make changes to PARENTAL controls, Highlight SYSTEM LOCK then press the ► button to ON.

#### NOTE:

RRT Setting and Reset RRT are not user's adjustable settings.

## TV SETUP



### LOCK(PARENTAL) MENU

In the LOCK(PARENTAL) menu you may block television and movie programming based on U.S TV and movie rating guidelines. To gain access and select your preferences within the LOCK(Parental) menu make certain your input is set to TV.

#### How to Navigate:

Press the MENU button on the remote control. Navigate using the ◀▶ buttons to select LOCK (Parental).

Press the ▼ button to highlight ENTER PASSWORD. Enter your 4 digit code (factory default code is "0000") unless previously changed.

To set parental controls for television programming or DVD movies, press the ▲▼ buttons to highlight US. Navigate using the ◀▶ buttons to highlight TV/MPAA menu.



Highlight TV, then press the ▶ button to enter the TV Ratings menu to select your preference.

Age	Defined as
TV-Y	Recommended for all children.
TV-Y7	Directed to older children.
TV-G	General Audience.
TV-PG	Parental Guidance Suggested.
TV-14	Parental Strongly Cautioned.
TV-MA	Mature Audience only.

Contents	Defined as
FV	Fantasy Violence
D	Suggestive Dialogue
L	Strong Language
S	Sexual Situations
V	Violence



Rating	Defined as
N/A	Not rated.
G	GENERAL AUDIENCES, Suitable for all ages.
PG	PARENTAL GUIDANCE SUGGESTED - Some material may not be suitable for children.
PG-13	PARENTS STRONGLY CAUTIONED - Some material may be inappropriate for children under 13.
R	RESTRICTED, Under 17 requires accompanying parent or adult guardian for viewing in movie theaters.
NC-17	No one 17 or under admitted in movie theater.
X	Adult audience only.

Highlight MPAA then press the ▶ button repeatedly to select your movie rating preference.

## TV SETUP



### LOCK(PARENTAL) MENU

In the LOCK(PARENTAL) menu you may block television and movie programming based on Canadian TV and movie rating guidelines. To gain access and select your preferences within the LOCK(Parental) menu make certain your input is set to TV.

#### How to Navigate:

Press the MENU button on the remote control. Navigate using the ◀▶ buttons to select LOCK. Press the button to highlight ENTER PASSWORD. Enter your 4 digit code (factory default code is "0000") unless previously changed.

To set parental controls for television programming or DVD movies, press the ▲▼ buttons to highlight Canada. Navigate using the ◀▶ buttons to highlight Canada English/Canada French menu.



Rating	Description
E	Exempt.
C	Children.
C8 +	Recommended for children age 8 and older.
G	GENERAL AUDIENCES, Suitable for all ages
PG	PARENTAL GUIDANCE SUGGESTED -Some material may not be suitable for children.
14 +	Viewers 14 years and older
18 +	Adult Programming.

Navigate using the ▼ button to highlight CANADA ENGLISH, then press the ▶ button repeatedly to select your ratings preference.



Rating	Description
E	Exempt.
G	GENERAL AUDIENCES, Suitable for all ages.
8 ans+	Not recommended for young children.
13 ans+	Not suitable for children under the age of 13.
16 ans+	Not suitable for children under the age of 16.
18 ans+	Adult Programming.

Navigate using the ▼ button to highlight CANADA FRENCH, then press the ▶ button repeatedly to select your ratings preference.

#### NOTE:

When adjustments are completed, you may select another menu by pressing the Menu button.



# TV SETUP



## TV(CHANNEL) MENU

The TV(CHANNEL) menu provides for the setup of your television to receive TV channels, store your favorites, add or skip channels and label them by their call letters.

### How to Navigate:

Press the MENU button on the remote control. Navigate using the ◀▶ buttons to select TV. Press the ▼ button to highlight your preferences.



Highlight FAVORITE to add channels to your Favorites List. Navigate using the ▲▼◀▶ buttons to select channels to be added or deleted from your list. Press the ENTER button to add or delete a channel. A checkmark indicates a channel has been added. You may also display your favourite list from the remote control by pressing FAV.



Highlight to select Show/Hide or skip channels already in memory. Navigate using the ▲▼◀▶ buttons to access the list of available channels. Press the ENTER button to change the channels status. A checkmark indicates a channel has been added.



Highlight CHANNEL LABEL to name or rename a broadcast channel. Navigate using the ▶ button to enter the screen menu to re-label a channel. Use the ▲▼ buttons to spell out each letter, number or character. Use the ◀▶ buttons to advance to the next space.

## TV SETUP

### ZOOM MODE

Press the MENU button on the remote control.  
Navigate using the ◀▶ buttons to select **Picture**.  
Use the ▼ button to highlight Zoom Mode.  
Navigate using the ◀▶ buttons to select the viewing mode: Normal > Wide > Zoom > Cinema.



### 1. NORMAL

Recommended for viewing native widescreen content and undistorted 4:3 images.  
(With Black Bars)



### 2. WIDE

Stretches certain 4:3 content and may reduce the black bars.



### 3. ZOOM

Stretches the image both vertically and horizontally to fill the screen when viewing widescreen content. The zoom effect will crop images somewhat.



### 4. CINEMA

When viewing 4:3 content, Cinema mode will fill the entire screen eliminating the side black bars. It may also eliminate or reduce black bars on certain widescreen movies.



## DISPLAY MODE

### PC FORMATS

SUPPORTED PC INPUT MODE			
Resolution	Horizontal Scanning Frequency (kHz)	Vertical Scanning Frequency (Hz)	Form at
640 X 480	31.5	60.0	DOS
800 X 600	35.1	56.2	VESA
800 X 600	37.9	60.0	VESA
1024 X 768	48.4	60.0	VESA
1366 X 768	66.6	60.0	VESA

**NOTE:**

This product does not support the display mode not listed above.  
In order to achieve the best display effect, please select the above-listed 5 display modes input signal.

Because of the difference of display drivers output signal (especially non-standard signal output), the display image may appear little disturbance which can be adjusted on the PC menu.

To prolong this unit's service life, please set your computer to power management mode.

## DISPLAY MODE

### VIDEO FORMATS

SUPPORTED COMPONENT/ HDMI INPUT MODE			
Resolution	Horizontal Scanning Frequency ( kHz )	Vertical Scanning Frequency (Hz)	Format
720 X 480	31.47	59.94	480 i
720 X 480	15.734	59.94	480 p
1280 X 720	37.5	50	720 p
1280 X 720	45	60	720 p
1920 X 1080	31.25	50	1080 i
1920 X 1080	33.75	60	1080 i
1920 X 1080	27	24	1080 p
1920 X 1080	56.25	50	1080 p
1920 X 1080	67.50	60	1080 p

#### NOTE:

The above listed formats are also related to the AV devices you are about to connect. Before you connect this unit with others please read all instructions carefully and make sure all necessary cables are connected.

This unit may be incompatible with some other formats which are not meet the above conditions.

# DVD Operation

## Basic Operation

- A. Press the Power button on the TV or the remote control ,and select “DVD”source by the SOURCE.
- B. If no disc is inserted yet, the display shows ‘No Disc’.Insert a DVD with the printed side facing towards the rear of the TV/DVD Player.the player will automatically draw the disc into the player.
- C. Most DVDs will show some preliminary information then stop at a main menu screen.
- D. Press PLAY/PAUSE to play it directly.
- E. After playback, press the EJECT button on remote control or EJECT button on TV to remove the disc.

Note: Sometimes a message “No function” or  image may appear on the screen. That indicates the function you just operated is not supported or unavailable now.

## General Setup

### TV Display

#### 4:3 Pan Scan

This is selected when the DVD player is connected to a normal TV.Wide-screen images are shown on the screen,but with some parts cut automatically.

#### 4:3 Letter Box

This is selected when the player is connected to a normal TV.Wide-screen images are shown on the screen,with black belt on the top and bottom.

#### 16:9

This is selected when the player is connected to a 16:9-screen TV.



### OSD Language

This is used to select the OSD language



### Last Memory

This setting enables you to watch the DVD from the last point it was turned off ,(for example changing the source to watch TV )

**ON** (Activate the last memory function )

**OFF** (Deactivate the last memory function )





## AUDIO Setup

### Downmix

#### LT/RT

A disc recorded multi channel soundtrack ,the output signal will be incorporated to left and right channel .

#### Stereo

A disc recorded multi channel soundtrack ,the output signal will be incorporated to stereo .



## Preference Setup

### TV Type

#### PAY

This is selected when the player is connected to a PAL System TV .

#### Auto

The player will set the TV system according to the disc in the tray .

#### NTSC TV

This is selected when the player is connected to a NTSC System TV .



### Audio

If a language listed below is recorded on the disc ,you can play the sound in that language ,  
If not, the language recorded will be used.





### Subtitle

If a language listed below is recorded on the disc ,you set the subtitle to be displayed in that language . If not , the language recorded will be used.



### Disc Menu

If a language listed below is recorded on the disc , you can set the Menu to be displayed in that language . If not , the language recorded will be used.



## Parental

When playing disc with parental lock function ,you may select an Age Control Grade according to grade of disc and your own preference . For example ,if PG is selected,DVD Video disc rated higher than the PG grade cannot be player .

## KID SAFE

G

PG

PG 13

PGR

R

NC17

ADULT



## Password

The user can change the password that is required when the user wants to change the Age Control Grade in the Parental Lock function .

NOTE:Default password is 0000

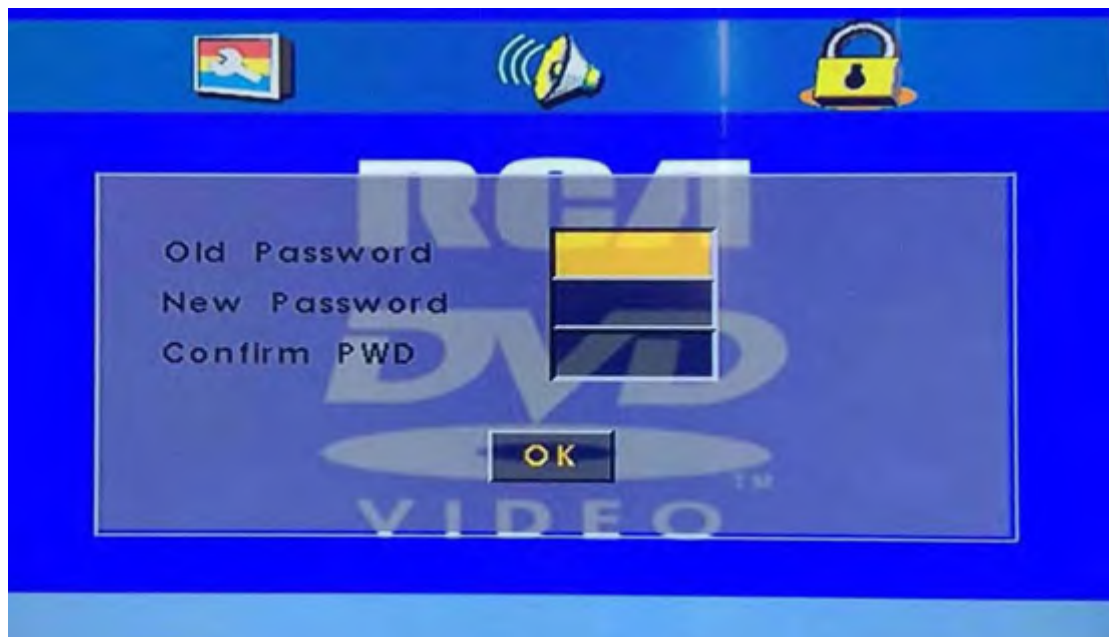

### Default

The user can load the original factory setting by choose RESET and press OK button.



## SPECIFICATION

ModelDescription		32" LED TV/DVD COMBO
Panel	Panel Type	LED Panel
	Diagonal Size	32 inches
	Screen Format	16:9
	Resolution	1366 x 768
	Brightness	200
	Contrast	5000:1
	View Angle	176(H)/176(V)
	Response Time	7ms
	Maximum Color	16. 7M colors
	Refresh Rate	60Hz
Systems	Color System	ATSC/NTSC
	Sound System	M
	Audio System	MTS
	Sound Output	L/RSpeaker: 7W + 7W
Input / Output Jacks	RF Input	75 ohm external terminal
	HDMI Input	Video: 480i,480p,576i,576p,720p,1080i. Audio: Two channel linear PCM32, 44.1 and 48kHz , 16, 20 and 24bits
	PC-RGB Input	D-sub 15pin G: 0.7Vp-p, 75 ohms B: 0.7Vp-p, 75 ohms R: 0.7Vp-p, 75 ohms
	Composite Video Input	1.0 Vp-p, 75 ohms RCA
	Component / YPbPr Input	RCA Y: 1.0 Vp-p, 75 ohms, 0.3V negative sync Pb: 0.7Vp-p, 75 ohms Pr : 0.7Vp-p, 75 ohms
	Sound Input	Component AUDIO: For Component Audioinput AV AUDIO: For CVBS Audioinput PC AUDIO: For PC RGB Audio input 500mV rms, Impedance: 20k ohms
DVD	Disc Physical Format	DVD,CD,CD-R,CD-RW,DVD+/-R,DVD+/-RW
	DVD Video Output Format	PAL/NTSC
Power	Power pequirement	120V~60Hz
	Rated power consumption	65W

This manual is only for your reference.  
Specifications are subject to update without prior notice.

## Disc Care

### About Disc Terms

#### Title

Generally, pictures or music compressed on a DVD are divided into several sections, "title".

#### Chapter

The smaller section unit of picture or music in a DVD under the title, usually one title is comprised of one or more chapters and each of them is numbered for easy searching, but some discs may not have a recording chapter.

#### Track

A segment of picture or music on a CD, Each track is numbered for searching.

### Care of Disc

Video disc contains high-density compressed data that needs proper handling.

1. Hold the disc with fingers by outer edge and/or the center spindle hole. Do not touch the discs surface.
2. Do not bend or press the disc.

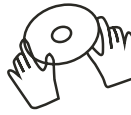

3. Do not expose the disc to direct sunlight or heating sources, Store discs in cabinet vertically, and in dry condition.

Prevent exposure to:

Direct sunlight

Heat or exhaust from a heating device

Extreme humidity

Clean the disc surface with a soft, dry cleaning cloth, Wipe the disc surface gently and radially from center toward the outer edge.

Do not apply thinner, alcohol, chemical solvent, or sprays when cleaning. Such cleaning fluids will permanently damage the disc surface.



## TROUBLESHOOTING GUIDE

SYMPTOM	CAUSE (AND REMEDY )
TV	
Bad Picture (snow, multiple images distortion, blurry)	<ul style="list-style-type: none"> <li>• Check the location of the antenna and adjust it if necessary.</li> <li>• Make sure the antenna cable is firmly connected.</li> <li>• Make sure all input cables are firmly connected.</li> </ul>
No sound.	<ul style="list-style-type: none"> <li>• Increase the volume.</li> <li>• Check whether the mute function has been activated on the Remote Control.</li> </ul>
Black and White picture.	<ul style="list-style-type: none"> <li>• Check the PICTURE setting within the PICTURE menu.</li> <li>• Check to make sure the program you are watching is broadcast in Color and not Black &amp; White.</li> </ul>
No picture or sound.	<ul style="list-style-type: none"> <li>• Make sure the unit is plugged in and turned on.</li> <li>• Make sure that the ATV mode is selected.</li> <li>• Try a new channel to check for possible station trouble.</li> <li>• Make sure the antenna is connected properly.</li> <li>• Increase the volume.</li> <li>• Make sure the antenna or audio/video source device is working properly.</li> <li>• Make sure all cables are firmly connected.</li> <li>• Check for local interference.</li> </ul>
Colored patches of picture.	<ul style="list-style-type: none"> <li>• Make sure there are no unshielded electrical devices nearby that are causing interference.</li> <li>• Turn the TV off for 30 minutes, then try it again.</li> </ul>
Panel function key does not respond correctly.	<ul style="list-style-type: none"> <li>• Under the influence of electrostatic phenomenon, the product may malfunction and require user power reset.</li> <li>• Unplug and re-plug the AC power cord.</li> </ul>
The display monitor's panel goes hot.	<ul style="list-style-type: none"> <li>• LED TV takes inside light phosphor. It may increase the temperature of the screen in some occasions. It's not a defect.</li> </ul>
Unusual dots	<ul style="list-style-type: none"> <li>• Black dots and Bright points may appear on the LED screen. This is a structural property of the LED panel and is not a defect.</li> </ul>
Stripes on screen	<ul style="list-style-type: none"> <li>• Adjust the impulse phase may decrease stripes. ( RGB in )</li> </ul>
The top of the monitor gets hot .	<ul style="list-style-type: none"> <li>• It may occur during long-time working. It's not a defect.</li> </ul>
Unable to select a certain channel.	<ul style="list-style-type: none"> <li>• The channel may be skipped. Choose this channel by directly selecting the buttons from the remote control.</li> </ul>
Disorder display at power on.	<ul style="list-style-type: none"> <li>• This may be caused because of a very short interval between POWER OFF and ON.</li> <li>• Unplug the power and restart.</li> </ul>

## TROUBLESHOOTING GUIDE

SYMPTOM	CAUSE(ANDREMEDY)
DVD	
Will not accept disc	DVD not selected ; Select DVD mode with source button .
Screen shows "NO DISC "	Disc placed incorrectly ; Disc must have mirror side facing you if single sided. Disc damaged or dirty ; Inspect disc.if damaged you must discard. If dirty see "disc care" page39.
Picture "freezes"or breaks up	Disc damaged or dirty ; See "disc care" page39 .
Certain disc functions not working.	Disc may not support required feature ; Read disc information.